

Brighton Marina Neighbourhood Plan

Consultation Draft 2022



Contents

Foreword	3
Introduction	4
The neighbourhood area	6
Development history	7
25 years of development progress at Brighton Marina	8
Demographics and Economy	9
Key development pressures and issues	10
The Vision and Objectives	11
Brighton Marina Neighbourhood Forum Vision Statement	12
The planning policy context	13
The Neighbourhood Plan Policies	15
Non land use Community Actions	24
Appendices	26

.....

**The constitution of the Brighton
Marina Neighbourhood Forum
states that its purpose shall be:**

‘to produce a Neighbourhood
Plan to further the social,
economic and environmental
well-being of individuals living,
or wanting to live, in Brighton
Marina and shall promote and
improve the social, economic and
environmental well-being of the
area including actions that deliver
a Neighbourhood Plan and enable
community views and choices
to be more effectively made’.

.....



Foreword

A neighbourhood plan is a document that sets out planning policies for a neighbourhood area. It is used alongside Local Authority and Government planning policies to decide whether to approve planning applications for the area, including new buildings or changes to existing buildings.

Neighbourhood plans are written by people who live or work in the local community and so they know the area and want to ensure that the community gets the right type of development, in the right place. Neighbourhood planning is supported by central government through the Localism Act of 2011.

Brighton & Hove City Council formally designated the Brighton Marina Neighbourhood Forum and the Brighton Marina Business/Neighbourhood Area (shown in the plan below) for a 5-year period on 18 June 2015. It was re-designated for a further 5-year period on 3 November 2020.

At the first Annual General Meeting of the forum in June 2017 a six-member steering committee was elected by forum members. The steering committee is tasked with steering the neighbourhood plan making process and general progressing the work of the forum. The constitution requires that the steering committee consist of both residents of and workers in the designated area.

The steering committee members are: Andrew Knight (*worker, chair*); Mike Hatch (*worker*); Mary Pett (*resident*); Keith Malcolm (*resident*); Ken Sainty (*resident*).

In producing this Consultation Draft plan the steering committee have been assisted by an independent consultant, Andrew Ashcroft BA(Hons), MA, DMS, MRTPI. Grant funding has been provided by the government to cover the costs incurred in the work of the forum.

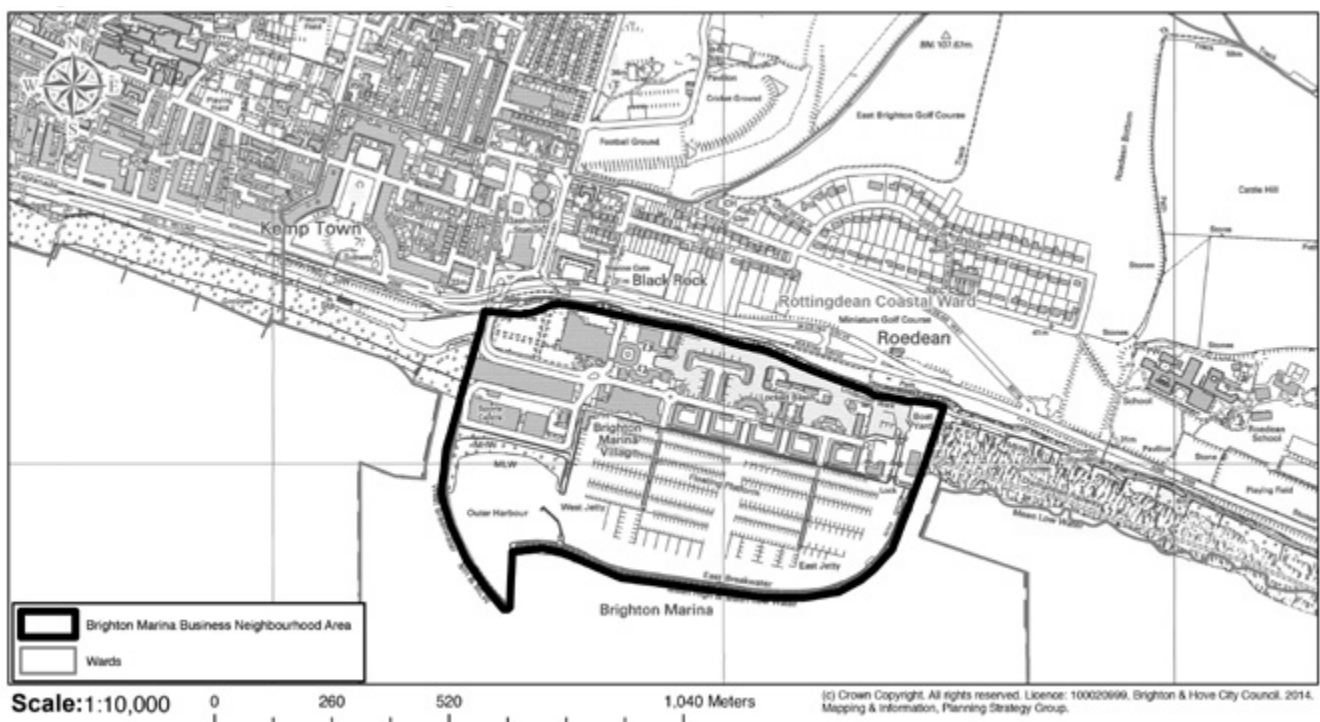

Introduction

The initiative to form the Brighton Marina Neighbourhood Forum, seek formal designation of the area and prepare a neighbourhood plan came from Marina workers and residents in 2014. The Localism Act provided the opportunity for designating neighbourhood areas; the Marina fitted clearly into the category of being a distinct neighbourhood area. Ongoing development at the Marina is envisaged within Brighton & Hove planning policy and the local plan. By having a neighbourhood plan the workers and residents of the Marina have the opportunity to bring their knowledge and experience of the area into the heart of the planning process, along with their commitment, vision and passion for the area.

The prospect of development usually brings some anxiety and fear associated with uncertainty. In the case of the Marina area this is accompanied by a widely held acknowledgement that large areas of the Marina have never achieved their potential and are in need of development. The Marina could be so much more than it is at present; for residents, for workers and for the City.



A timeline of progress towards a neighbourhood plan is as follows:

Date	Activity
September 2014	Application to Brighton & Hove City Council for designation of a neighbourhood forum and neighbourhood area.
June 2015	Forum and area designated by Brighton & Hove City Council.
June 2017	Inaugural Forum AGM and election of steering committee
October 2017	Forum website established www.bmnf.org.uk
May 2018	Forum AGM including presentation of a consultation on a draft vision statement for the forum. Amended forum constitution unanimously adopted.
September 2018	Forum 'Vision Statement' adopted.
November 2018	Consultant engaged to assist the work of the forum
May 2019	Forum AGM including consultation with attendees on policy areas for the neighbourhood plan.
September – October 2019	Community-wide survey of Marina residents and workers conducted. Results used to inform plan policy priorities.
2020-2021	Progress substantially delayed by the 'Covid-19' pandemic.
November 2020	Forum redesignated by Brighton & Hove City Council for a further five years.
February 2022	Draft plan policies submitted to Brighton & Hove City Council for 'screening.'
April 2022	Brighton & Hove City Council screening report determines that the policies as submitted would not require a strategic environmental assessment.
April 2022	Forum AGM held following the pandemic 'hiatus.'
Summer 2022	Drafting of 'consultation draft' plan.

Within this timeline is listed consultation carried out with both forum members and the Marina Community as a whole to discover the aspirations of the community for the Neighbourhood Area. Details of consultation exercises may be found at appendix C.

The neighbourhood area

The Designated neighbourhood area follows the boundaries of Brighton Marina. The unique feature of this area within the city of Brighton & Hove is that in its entirety it is reclaimed land in what was formerly the sea. Before the 1970s none of the land existed; all was under water. Nevertheless, the short history of the area has been quite full of activity.



Development history

First conceived as the vision of a Brighton businessman, Henry Cohen, in the 1960s, the Marina progressed through various legal hurdles: a public enquiry in 1966; a town vote; the Brighton Marina Act in 1968. Construction began in 1971 and continued through the '70s. The Marina opened to the public on 25th July 1978 and the official opening by HM the Queen was in May 1979.

Despite earlier plans for mixed use development, the Marina opened as just a harbour, and one with a significant financial debt resulting from higher than projected construction costs.

Big changes came in the second half of the 1980s when the Marina was purchased by the Brent Walker group. They formed new land areas (the inner harbour promontories and the Village Square) and developed the supermarket, cinema, car park, Village Square and the first residential properties. Brent Walker failed financially in 1991 and development at the Marina ceased.

Development began again in the first half of the '90s in the inner harbour with residential blocks by the developer Barratt Southern Counties. The buildings were in a different style to previously, described as 'insipid neo-regency' (*Pevsner guide*).



Further change came in 1996 when a Brighton Company, Brunswick Developments, purchased Brighton Marina Company. The following five years saw rapid development. Barratt continued building with the five large blocks South of the Strand Road, the East Lockside Offices were built as were the West Quay pub and 'Leisure sheds'. Brunswick sold areas of the Marina: Premier Marinas bought the harbour and Parkridge Developments bought the commercial areas where they developed the Waterfront building.

After a hiatus in development of some 10 years the Boardwalk Development was constructed, completing in 2016. This development is the first phase of a much larger consented scheme; the other phases have not proceeded to construction. The Marina's history can best be described as piecemeal development over 40 years.



25 years of development
progress at Brighton Marina

Demographics and Economy

Summary demographic data for the designated plan area is found below. This is sourced from OCSI data from Brighton & Hove City Council website.

This summary provides an overview of the residents of the area as background information. Whilst not directly pertinent to the neighbourhood plan it does give a sense of the area. For example the below average car ownership reinforces the importance of public transport for residents.

Alongside the residential estate the designated plan area also hosts significant economic activity across a very wide range of businesses. These encompass national chains, regional and local businesses and independent traders. Employment sectors include retail, leisure, hospitality, healthcare, business and professional services and marine related trades and engineering. The plan area contributes much employment to the City and wider area.



Population

There are 1,614 people living in Brighton Marina neighbourhood plan area



Education & skills

11% of people have no qualifications in Brighton Marina neighbourhood plan area compared with 22% across England



Vulnerable groups

9% of children aged 0-19 are in relative low-income families in Brighton Marina neighbourhood plan area compared with 19% across England



Economy

44% people aged 16-74 are in full-time employment in Brighton Marina neighbourhood plan area compared with 39% across England



Housing

2% of households lack central heating in Brighton Marina neighbourhood plan area compared with 3% across England



Access & transport

30% of households have no car in Brighton Marina neighbourhood plan area compared with 26% across England



Crime & safety

The overall crime rate is higher than the average across England



Communities & environment

The % of people 'satisfied with their neighbourhood' (85.9%) is higher than the average across England (79.3%)



Health & wellbeing

11% of people have a limiting long-term illness in Brighton Marina neighbourhood plan area compared with 18% across England

Oxford Consultants for Social Inclusion (OCSI), www.oci.co.uk / 01273 810 270. © OCSI 2020.

[This is a summary page from a report on the B&HCC website – <https://brighton-hove.communityinsight.org/>]

Key development pressures and issues

“Different construction phases within the Marina have occurred without the benefit of a planned approach. Consequently the Marina has become characterised by piecemeal development and areas of poor public realm.”

(B&HCC City Plan part 1, March 2016, DA2).

Although the City Plan refers to a ‘unique marine character,’ others have been less kind: “The architecture to date is worthless.” (*Brighton and Hove; Pevsner Architectural Guides. Nicholas Antram and Richard Morrice. Yale University Press 2008*).

In the work of the Neighbourhood forum to date, we have found a wide recognition that large areas at the West of the plan area are unattractive and of low quality.

Development has happened with no overall masterplan. This neighbourhood plan seeks to introduce policies which will improve this situation and make future developments take account of their context within the Marina. We must add value to what is already here. We must avoid repeating the planning mistakes of the past.



The Vision and Objectives

As the Neighbourhood Forum began meeting and consultation and discussion with members and the wider area community took place a high degree of consensus emerged in the aspirations expressed for the Marina. From the information collected the forum steering committee drafted a Vision Statement for the forum and this was consulted on at the forum AGM held on 16th May 2018 and adopted at the forum steering committee meeting on 24th September 2018.



Brighton Marina Neighbourhood Forum Vision Statement

We want Brighton Marina to be developed in a way that realises the full potential of this special place by the sea for residents, workers and visitors. Our shared aim for Brighton Marina is that future development of the Marina fulfils the objectives of supporting high quality of life, sustainability, connectedness and being a highly-valued asset. A place where residents, tourists and businesses all thrive.

Objectives:

High Quality of Life:

- A positive choice as a feel-good place to live, work and visit.
- Public spaces and facilities that are enjoyable places to be.
- Making the most of our location on the coast and by the sea.

Sustainability:

- Economically sustainable. A mix of residential and commercial premises and property uses that are always in demand, maximising numbers of people in the Marina throughout the year.
- Environmentally sustainable. Aiming to have a positive effect on the natural environment and marine wildlife, and to minimise negative impacts.
- Future sustainable. Able to respond to changing requirements and demand to provide a significant contribution to the City's need for homes, workplaces and leisure space.

Connectedness:

- Connected within itself. Development plans must bring stakeholders together to make a cohesive and enjoyable place for individual employees, residents, berth holders and visitors.
- Connected to the city. Joined up transport links and welcoming entrances for vehicles, pedestrians, cyclists and boats.
- Development should make the Marina better and easier for pedestrians to get around.
- Residents across long-standing and new developments have a great sense of community, respect and shared interests and work together to build a collective sense of pride and belonging.
- Represented in the city by being an electoral ward.

A Valuable Asset

- Valued as a unique part of the city. Brighton's marina and the City's access to the sea. The UK's largest marina.
- Valued for quality of management.
- Valued in the city and region for its positive environmental and economic contribution.

The planning policy context

The neighbourhood plan has been prepared in the context of an up-to-date planning policy context at both a national and local level. As such the Plan has sought to bring added value to this strategic context.

National policies

National planning policy is set out in the National Planning Policy Framework (NPPF). It was most recently updated in July 2021. In comments that the purpose of the planning system is to contribute to the achievement of sustainable development

Achieving sustainable development means that the planning system has three overarching objectives, which are interdependent and need to be pursued in mutually supportive ways (so that opportunities can be taken to secure net gains across each of the different objectives):

- **an economic objective** – to help build a strong, responsive and competitive economy, by ensuring that sufficient land of the right types is available in the right places and at the right time to support growth, innovation and improved productivity; and by identifying and coordinating the provision of infrastructure
- **a social objective** – to support strong, vibrant and healthy communities, by ensuring that a sufficient number and range of homes can be provided to meet the needs of present and future generations; and by fostering well-designed beautiful and safe places, with accessible services and open spaces that reflect current and future needs and support communities' health, social and cultural well-being; and

- **an environmental objective** – to protect and enhance our natural, built and historic environment; including making effective use of land, improving biodiversity, using natural resources prudently, minimising waste and pollution, and mitigating and adapting to climate change, including moving to a low carbon economy.

The NPPF also includes a series of more detailed sections on specific elements of the planning system. The following are particularly relevant to the Marina Neighbourhood Area:

- **Section 5** Delivering a sufficient supply of homes
- **Section 6** Building a strong competitive economy
- **Section 9** Promoting sustainable travel
- **Section 12** Achieving well-designed places
- **Section 14** Meeting the challenge of climate change, flooding and coastal change
- **Section 15** Conserving and enhancing the natural environment

The neighbourhood plan has sought to pursue these matters. They feature in the related policies.

Local policies

The Brighton and Hove City Plan Part 1 was adopted in March 2016. It provides the strategic context for the wider City.

The following policies in the Plan are of particular relevance to the designated neighbourhood area:

continued overleaf

Policy DA2 Brighton Marina, Gas Works and Black Rock Area: This is one of eight identified Development Areas in the City. The policy sets out a series of strategic development policies for the three areas.

In summary part B of the policy comments that provision will be made for the following amounts of additional development to be provided by 2030:

- 1,938 residential units (including the 853 residential units already granted planning permission for the outer harbour, 1000 residential units allocated for the inner harbour and 85 residential units allocated for the Gas Works site);
- 5,000 square m (net) retail (A1-A5) floorspace;
- 2,000 square m employment (B1a, B1c) floorspace;
- 10,500 square m of leisure and recreation floor space;
- A community building within the Marina;
- A health facility within or in the vicinity of the Marina to be agreed with the relevant NHS organisation;
- A primary school or increase in the number of school places within or in the vicinity of the Marina.

Policy CP5 Culture and Tourism:

Policy CP11 Flood Risk:

Policy CP12 Urban Design:

The City Plan Part 2 is now at an advanced stage. It was submitted for examination in May 2021 and the inspector's report was received in July 2022. It has been designed to complement Part 1 of the Plan and to provide more specific details.

DA2 Brighton Marina, Gas Works and Black Rock Area

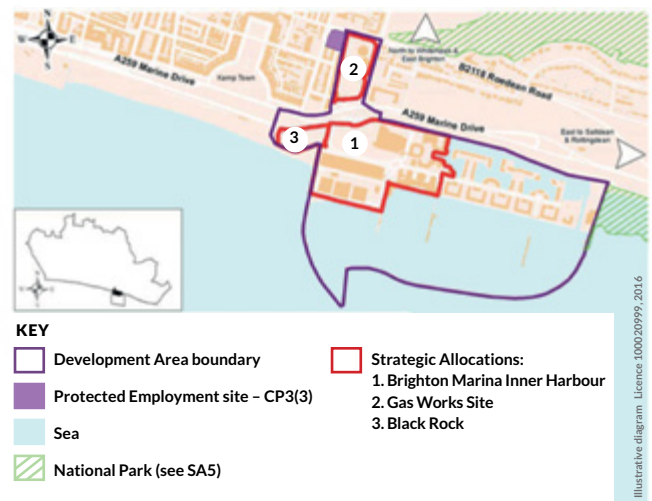

The following policies in the Plan are of particular relevance to the designated neighbourhood area:

Policy DM9 Community Facilities:

Policy DM14 Commercial and Leisure Uses at Brighton Marina:

Policy DM18 High Quality design and places:

Policy DM42 Protecting the Water Environment

The policies in the City Plan Parts 1 and 2 build on earlier work which was undertaken on the Marina. The Supplementary Planning Guidance Note 20 (Brighton Marina) included a development brief for the western half of the Marina. Thereafter the Brighton Marina masterplan (PAN04) was published in March 2008.

The neighbourhood plan seeks to bring added value to the policy context set by the City Plan. In addition it seeks to respond to the various design considerations in national policies, the City Plan and the earlier supplementary planning design and masterplan work.

The Neighbourhood Plan Policies

Policy in blue • Supporting text in black

Policy BM1: Design

New development within the Marina should be designed to reflect its relationship to the English Channel in general, and to the Marina in particular. As appropriate to its scale, nature and location, new development should respect its prominence and visibility from the waterside.

Development proposals will be supported that bring forward high quality design appropriate to their location within the Marina and their scale and which demonstrably address the following matters:

- the scale and massing of new buildings reflects the maritime setting of the Marina and contributes towards its attractiveness, interest and visual appeal;
- new buildings should relate sensitively and imaginatively to an overall development proposal/master plan for the Marina;
- any access arrangements are sensitive both to the development concerned and the wider Marina;
- the appearance of any access arrangements should be sensitive when viewed from the waterside; and
- any development must retain and improve the setback distance from the water's edge to improve pedestrian access and permeability adjacent to the waterside.

Proposals for major development should be designed so that they integrate into the layout, form and density of the wider composition and layout of the Marina with particular regard to connectivity both within the development and as it relates to pedestrian and traffic flows in/out of and around the marina.

Proposals for the development of a landmark building which otherwise complies with the general elements of this policy will be particularly supported.

In addition, public spaces within major developments should be secure, accessible, inclusive, connected and display the highest quality of design, landscaping, planting, street furniture and materials. This public realm should be comprehensible through the use of gateways, focal points and landmarks as appropriate to help people find their way around the development in general, and to the waterside and other key facilities within the wider Marina in particular.

This policy has been designed to have general effect within the designated neighbourhood area.

Whilst the local community acknowledges that the Marina has its role to play in assisting the development of new homes in the wider City, and the strategic growth proposed in the City Plan, it is anxious that any new development is to the highest standard and

continued overleaf

properly reflects its marine environment. This concern was expressed in the community consultation in Autumn 2019 (Questions 10 and 11) where the wider issue of design in the Marina achieved high scores.

This approach seeks to provide a local interpretation of Section 12 of the NPPF (2021). In particular it incorporates a local policy to deliver the ambitions of paragraph 130 of the NPPF for the design of planning policies.

The policy approach also takes account of the ongoing work of the Building Better, Building Beautiful Commission and the National Model Design Code.

Policy BM2: Public realm/open spaces

As appropriate to their scale and location new developments should incorporate public realm and/or open spaces development and should demonstrate good connectivity between buildings and spaces within the Marina and wider area.

Within the context of their wider development areas of public realm and other open spaces should demonstrate the ways in which they respond to the following matters:

- **Safety and Surveillance:** all new elements of public realm should be designed and laid out so that they would be safe to all users during the day and the night. Where it is practicable to do so areas of public realm and open space should be overlooked by their associated developments.
- **Attractiveness:** all new elements of public realm should be designed and laid out in an attractive way to meet the needs of both local residents, boat owners using the Marina and other visitors.

Proposed developments which do not demonstrate appropriate responses to these design principles will not be supported.

This policy is important in its own right. It also overlaps with Policies BM1: Design and BM3: Connectivity.

The Marina is an attractive part of the City. It is popular with residents and visitors alike. Nevertheless, its development in phases over time has resulted in an overall environment that is not as well-connected as it could have been. This means that accessibility within the Marina is limited in places. In particular, the quality of the public realm does not contribute either to wider accessibility or to connecting the different elements of the wider area.

This Plan recognises that new development does not necessarily need to address existing issues with the wider public realm. Nevertheless, new developments which provide solutions to any such issues will be particularly supported. Proposals for public art within the wider public realm will be welcomed.

The policy approach also takes account of the ongoing work of the Building Better, Building Beautiful Commission and the National Model Design Code.

A wish for improved design of public realm and open spaces achieved high scores in the feedback to the community consultation in Autumn 2019 (*Questions 13 and 14*).

Policy BM3: Connectivity

Connectivity: all new elements of public realm should be designed and laid out so that they are connected in a sensitive, legible and imaginative way both to its related development and to other adjacent developments and associated public realms

Development proposals will be welcomed which address the difficulties for pedestrians getting around the Marina, in particular:

- Joining up the Coastal path through the Marina
- Making it possible to walk around the marina in a safe, pleasant environment
- Improving the pedestrian access from the beach / Blackrock

Consultation with Marina residents and workers has highlighted issues of connectivity, and the current difficulties of getting around within the marina on foot, particularly around the western end. Pedestrian routes in and out of the Marina are of poor quality and do not feel safe.

Development proposals should keep dirty and/or noisy uses away from areas of high pedestrian footfall.

Policy BM4: Residential Development

Proposals for new residential development will be supported where it delivers the strategic allocation for the Marina as identified in City Plan Part One.

Proposals for new residential development should incorporate the following three design principles as appropriate to their scale and location:

- **Access and permeability:** new developments should secure improved legibility, permeability and connectivity for pedestrians within and to the Marina and the surrounding areas through high quality building design, townscape and public realm;
- **High Quality Design:** new developments should be of a high quality with excellent use of durable materials to reflect the unique location and surroundings of the Marina; and
- **Housing Type and Mix:** new developments should provide for a mix of dwelling type, tenure and size to cater for a range of housing requirements and to improve housing choice.

Proposed developments which do not demonstrate appropriate responses to these design principles will not be supported.

This policy acknowledges that the Brighton and Hove City Plan Part One includes strategic residential proposals for the Marina. The Neighbourhood Plan supports such development.

Policy BM4 has been designed to add complementary detail to Policy DA2 of the City Plan Part One. The Neighbourhood Forum will work with the City Council on a holistic approach to the regeneration of the development area will be achieved through the preparation and adoption of a Supplementary Planning Document (SPD) for the Brighton Marina and wider area. Once adopted the SPD will replace the existing Supplementary Planning Guidance (SPGBH20, 2003) and Planning Advice Note (PAN04, 2008) for Brighton Marina. The policy takes direct account of the 2008 Planning Advice Note.

The importance of securing an appropriate mix of housing types in new development at the Marina is an important element of the policy. It takes account of community feedback in Autumn 2019 and the range of housing and affordability issues in the City in general, and in the Marina in particular.

Policy BM5: Natural Environment/ Marine Wildlife

Development proposals should respect the natural environment within which the Marina is located.

Proposals for new development should incorporate the following environmental design principles as appropriate to their scale and location:

- **Mitigation of Flood Risk:** new development should demonstrate that it will be safe, will not increase the risk of flooding elsewhere and where possible, will reduce the overall flood risk profile at the Marina. All new development should comply with the Sea Defence Management Plan of the Brighton Marina Estate Management Company. A Flood Risk Assessment will be required for proposals for new build development.
- **Integrity of the cliffs to the north of the Marina:** new developments should demonstrate that their proposals do not impact adversely on the visibility or stability of the cliffs to the north of the Marina. The cliffs are noted for their unique and irreplaceable geological features.
- **Water Quality:** new developments should demonstrate the way in which they would handle surface water runoff issues and their potential impact on the quality of the water environment both within the immediate environment of the Marina and more widely in the English Channel.

Proposed developments which do not demonstrate appropriate responses to these design principles will not be supported.

This policy recognises the importance of ensuring that new development takes account of the very special circumstances of the Marina and its marine setting. It overlaps with the separate responsibilities of the Brighton Marina Estate Management Company.

The approach taken seeks to reflect Section 14 of the NPPF. In particular it takes account of climate change, rising sea levels and the relationship between the Marina and the chalk cliffs to its immediate north.

Policy BM6:

Cafes, restaurants, retail facilities and other commercial facilities

The neighbourhood plan supports the availability of a wide range of retail and commercial facilities in the Marina.

Insofar as planning permission is required, proposals for the use of existing commercial floorspace for commercial, business and service uses will be supported, particularly uses that are complementary to the harbour and marine activities.

Proposals for the use of land and/or buildings for boating, leisure and recreational activities will be particularly supported.

This policy reflects the attractiveness of the Marina to visitors and tourists. One of its defining features is the availability of cafes and restaurants.

The policy has been designed to be compatible with the 2020 version of the Use Classes Order which seeks to provide as much flexibility as is reasonably possible for commercial and business uses. This reflects the wider national approach which aims to respond efficiently to changing business opportunities and practices in general, and in response to the Covid pandemic in particular. It offers specific support to a wide range of facilities which would underpin the marine and other leisure activities which take place from the Marina

The wider issue of commercial facilities in the Marina achieved high scores in the feedback to the community consultation in Autumn 2019 (*Questions 2, 7, 16 and 17*).

Policy BM7:

**Energy use, waste
minimisation and
recycling**

Development proposals should demonstrate the highest standards of energy use, waste minimisation and recycling.

Proposals which incorporate zero carbon construction energy initiatives, which provide for a reduction in vehicle movements, which provide recharging facilities for electric vehicles and any other similar initiatives which would reduce carbon emissions at the Marina will be particularly supported.

All new residential development must include charging facilities for electric vehicles in all parking spaces provided.

Policy BM8: Community Facilities

The neighbourhood plan identifies the following uses as key community facilities:

- Pharmacy (Asda Pharmacy)
- Public House (Master Mariner)

Insofar as planning permission is required, proposals for the change of use of the key community facilities to other uses will not be supported unless:

- they include the replacement of the existing community facility in an accessible and convenient location; or
- it can be demonstrated that there is no need for the community facility and that there is no reasonable prospect of the property concerned being occupied by an alternative community or social use; or
- it can be demonstrated that the continued use of the premises concerned by the existing community use is unviable.

Proposals that would result in the availability of additional community facilities (Use Classes E(e), E(f), F1 and F2 in the neighbourhood area will be supported where they would not have an unacceptable detrimental impact on the amenities of any residential properties in the immediate locality.

Proposals that would result in the opening of a GP surgery, a Post Office or provision of community meeting space would be particularly supported.

This policy acknowledges that the Marina provides a range of community facilities for its resident and visitor population.

It has two related parts. The first identifies key community facilities and designs a policy to safeguard them other than in a series of defined circumstances. The second offers support for new community facilities. It offers particular support for proposals that would result in the opening of a GP surgery or a Post Office or provision of community meeting space. They are key facilities sought by the local community and their availability would add significantly to sustainable development in the neighbourhood area.

The wider issue of community facilities in the Marina achieved high scores in the feedback to the community consultation in Autumn 2019.

Non land use Community Actions

The Plan has a clear focus on setting out a series of policies for the development and use of land. This reflects the approach in planning practice guidance and that, if made, the Plan will become part of the development and be used to determine planning applications.

National guidance also allows neighbourhood plans to include wider community aspirations than those relating to the development and use of land. Such aspirations have been identified as the Plan has been prepared. As indicated in national guidance the aspirations are clearly identifiable from the policies and are set out in the separate section of the Plan. The Aspirations will not form part of the statutory development plan.

The Aspirations recognise the role which the Forum plays within the wider life of the Marina. They have a specific focus on travel and access (CA1), tourism and leisure (CA2) and the cultural life of the Marina (CA3).

In their different ways the Aspirations will have natural overlaps with the land use policies in the Plan.

BMCA1: Access/Transport

The Forum will work with BHCC, the Brighton and Hove Bus and Coach Company Limited and other local agencies to improve the access and relationship between the Marina and the wider City.

In particular the following projects and aspirations will be developed within the Plan period:

- Improving the accessibility of the Coastal Path into and out of the Marina;
- Integrating the Marina with emerging City-wide infrastructure projects;
- Encouraging the development of sustainable modes of transport; and
- The introduction of an express bus service between the City Centre and the Marina.

BMCA2: A Valued resource and an Active destination for visitors

The Forum will work with BHCC, Visit Brighton, the Brighton and Hove Bus and Coach Company Limited and other local agencies to improve the awareness of the distinctive nature of the Marina and its relationship with the wider City.

In particular the following projects and aspirations will be developed within the Plan period:

- Promoting the availability of specialist marine and restaurant facilities at the Marina;
- Promoting short break holidays with local hotel operators and commercial marine operators in the Marina

- Promoting the Marina as a key location along the Shoreham-on-Sea to Eastbourne section of the England Coast Path
- Incorporating the Marina as a venue into the festival, the Great Escape and the Fringe within the wider City activities
- Undertaking a feasibility study on the development of a performance space/music venue.

BMCA3: Public Art

The Forum will work with the artist communities to explore opportunities to incorporate public art within the wider public realm.

The Forum will also support wider initiatives by developers and/or commercial organisations to sponsor or facilitate the availability of public art in the Marina.

BMCA4: Air Quality

The Forum will work with public and private bodies to ensure that the air quality in the Marina is of the highest possible standards and which reflects its maritime environment.

Where necessary the Forum will work with BHCC and any other relevant agencies to rectify any air quality issues which may arise in the Plan period.

BMCA5: Boundary Review

The Forum aspires for the Marina to be a City Council electoral ward in its own right. The Forum will work with the Council to bring forward a boundary review at the appropriate time to achieve this.

Monitoring and Review

The Plan has been developed within a positive and up to date planning policy context. The Brighton and Hove City Plan Part 1 was adopted in March 2016 and the Inspector's report has recently been received in relation to Part 2 of the Plan.

Decision-making

The Forum acknowledges its responsibility to ensure that the neighbourhood plan is properly applied in decision-making. In this context it will comment on planning applications in general, and draw to the attention of the City Council when it considers that planning applications deliver the policies in the Plan and where they may conflict with the Plan's approach.

Monitoring the effectiveness of the Plan

The Forum will also monitor the outcome of planning applications and the effectiveness of the policies in the Plan.

The Forum will invite the City Council to meet with the Forum twelve months after the Plan is made so that its initial effectiveness in the development management process can be assessed.

In the event that certain policies are proving to be ineffective or are not serving their intended purpose the Forum will consider the need for a partial review of the Plan.

Review of the Plan

The Forum acknowledges its responsibility to ensure that the Plan is kept up to date and, where necessary, responds positively to changes in local or national planning policy.

continued overleaf

The Forum will monitor any updates to national planning policy and to the Local Plan and assess the need for any partial review of the Plan.

The Forum will assess the need for a full review of the Plan at the earliest of the two following events:

- Within six months of the adoption of a revised version of the City Plan; or
- Five years from the making of the neighbourhood plan.

Appendices

A. Marina survey and responses

A survey of the Marina Community was carried out by the Neighbourhood Forum in the Autumn of 2019. A report on the responses received can be found on the forum website here: <https://www.bmnf.org.uk/community-survey-report>

B. Council policy screening report

The draft policies contained in this plan have been screened by Brighton & Hove City Council in April 2022. The screening report can be found on the Council's website here:

<https://www.brighton-hove.gov.uk/planning/strategic-environmental-assessment-screening-report-and-consideration-habitats-regulations>

C. Consultation activities carried out by the Forum

i. activities at meetings:

- 16th May 2018; consultation on the proposed forum vision statement at the full forum meeting.
- 15th November 2018; consultation on the outer harbour development proposal at the full forum meeting
- 16th May 2019; consultation on draft plan policies at the full forum meeting.

ii. community survey (A, above)

D. Local plan material about the Marina

Brighton & Hove City Council Local Plan Policy DA2 relates to Brighton Marina, Gas Works and Black Rock Area. The plan can be found on the Brighton & Hove City Council Website here:

<https://www.brighton-hove.gov.uk/planning/planning-policy/city-plan-part-one>



Brighton Marina Neighbourhood Forum

c/o Brighton Marina Administration Office,
Brighton Marina, Brighton, BN2 5UF

Email: neighbourhoodforum@brighton-marina.co.uk

Website: www.bmnf.org.uk

